

North
Legend

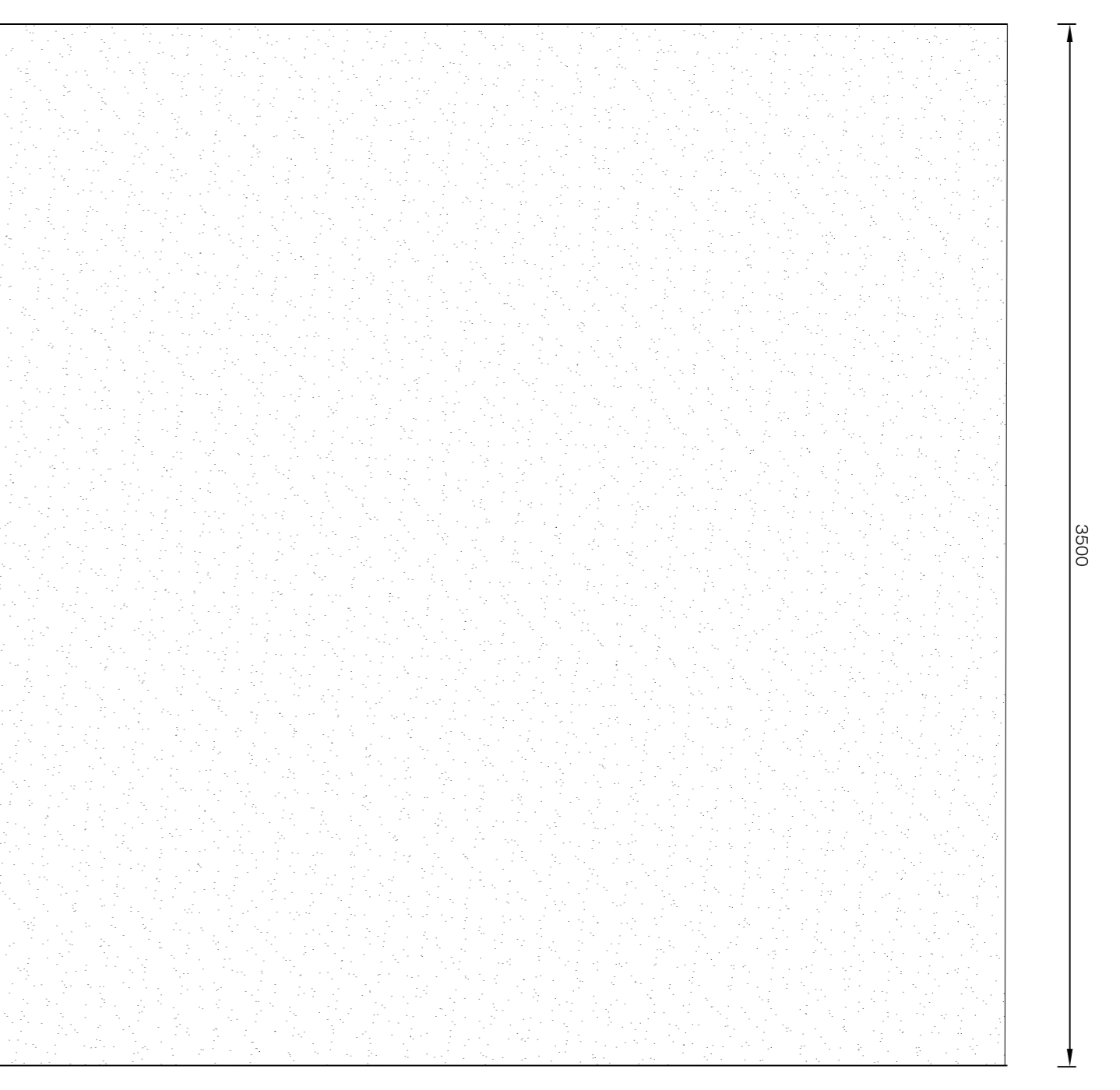

Plan,  
Scale @ 1:20

D 01 LD-06-PP Plan to 3500mm wide grass filter route for Emergency vehicles to the West of Block D and E.  
Scale @ 1:20

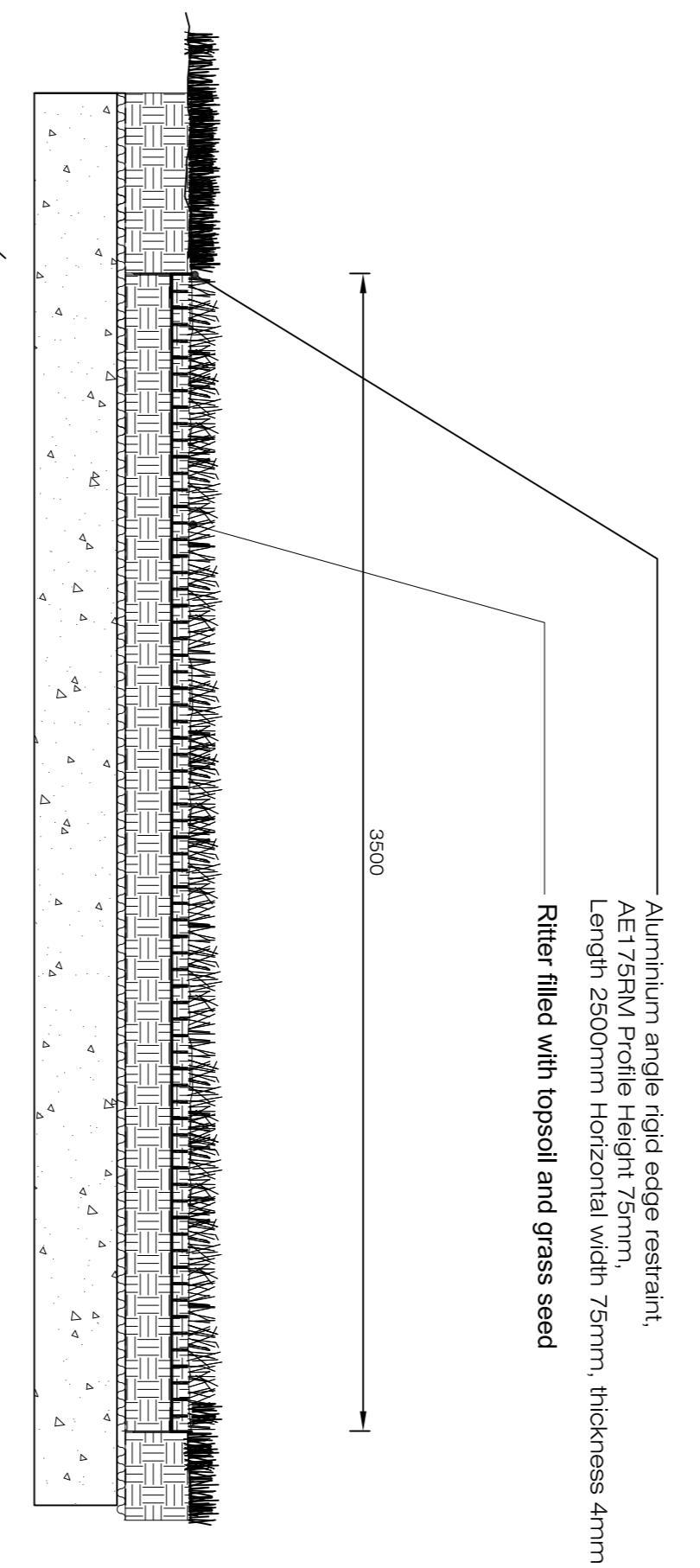

Section A-A,  
Scale @ 1:20

D 01 LD-06-PP Section through reinforced grass filter pathway to the west of Block D and E.  
Scale @ 1:20

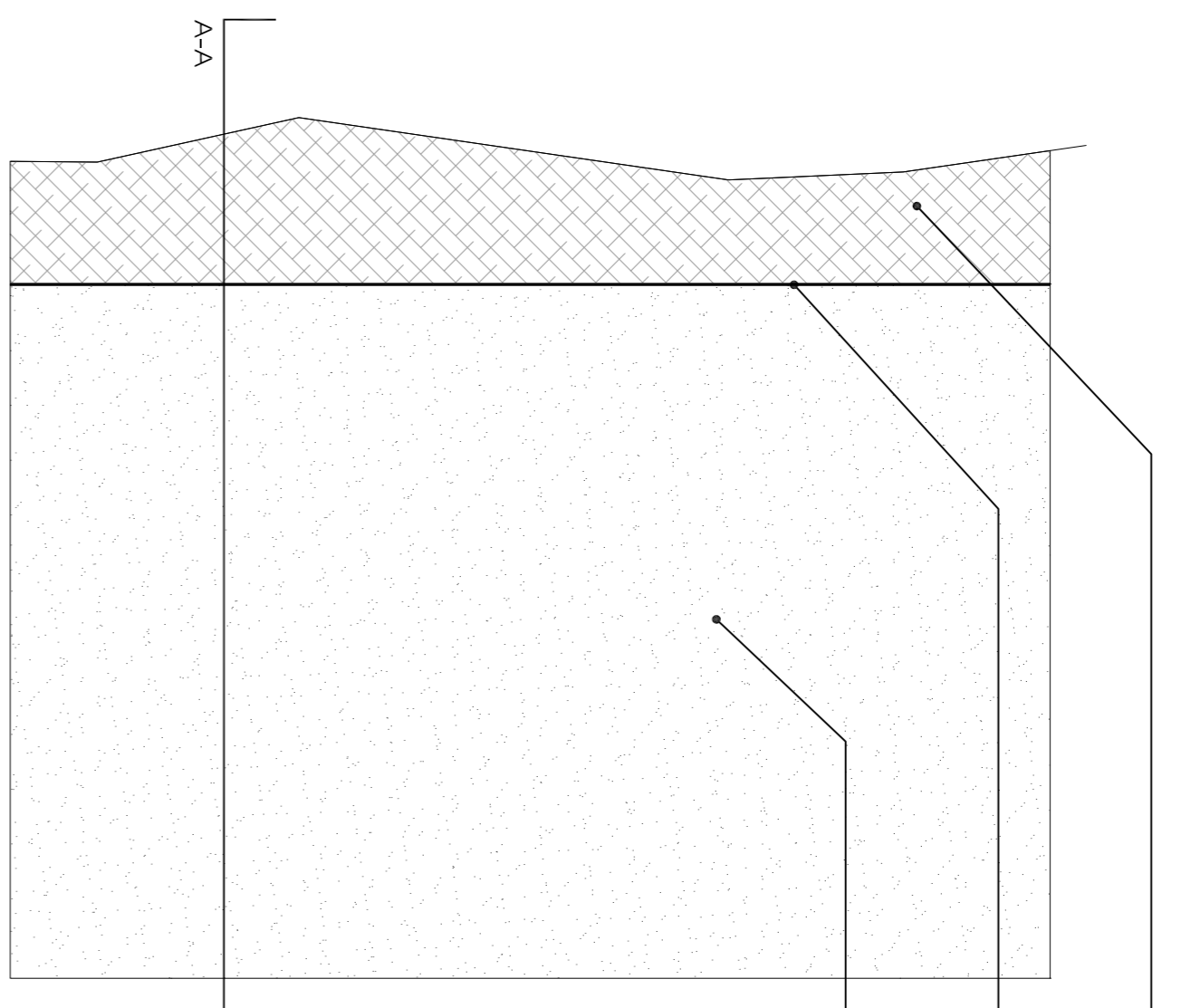

D 02 LD-06-PP Plan of self binding gravel surface to podium amenity areas.  
Scale @ 1:20

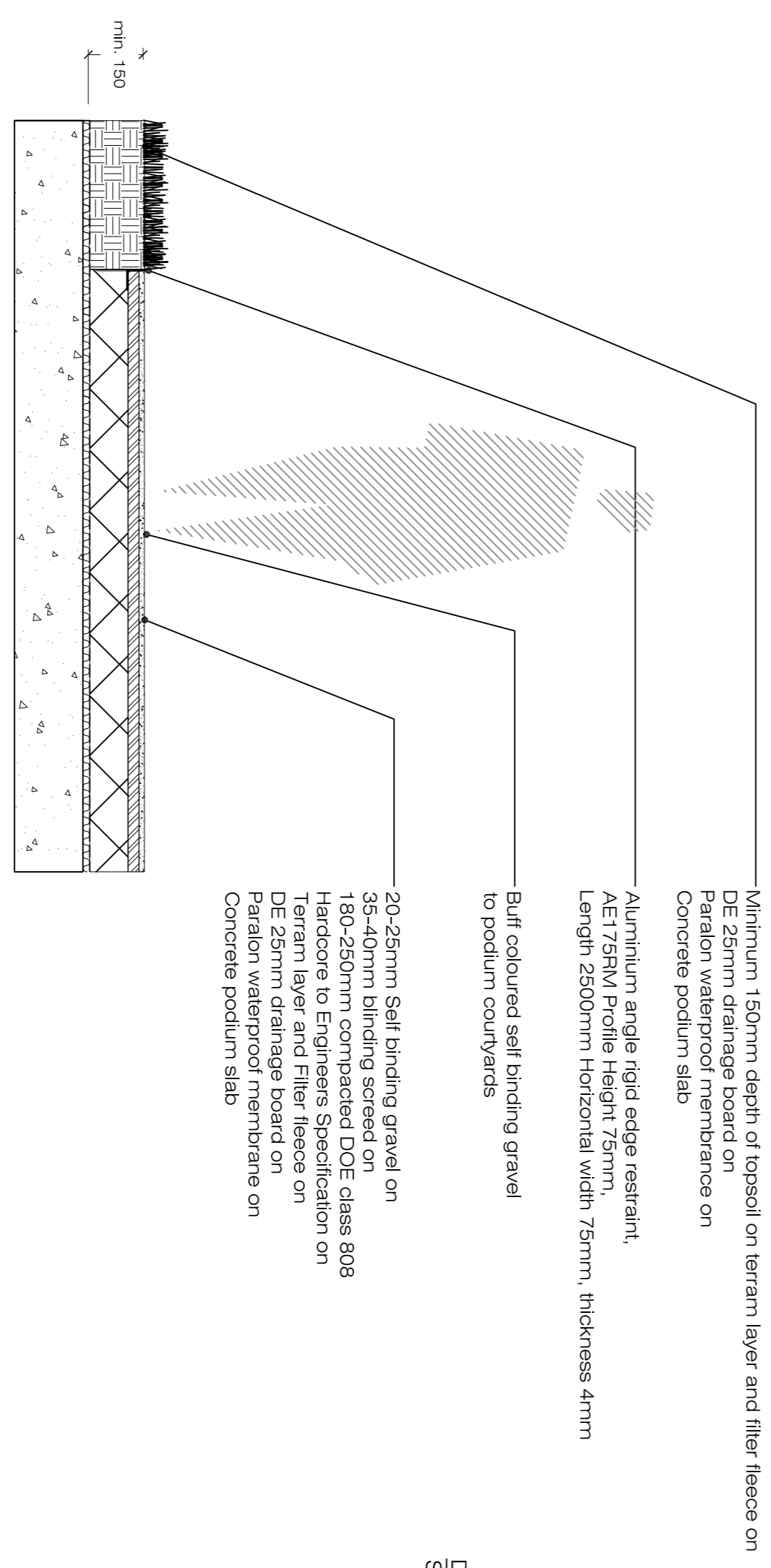

Section A-A,  
Scale @ 1:20

D 02 LD-06-PP Section to self binding gravel surface to podium amenity areas with edge treatment to grass area.  
Scale @ 1:20

- Minimum 150mm depth of topsoil on terran layer and filter fleece on DE 25mm drainage board on Paralon waterproof membrane on Concrete podium slab
- Aluminium angle rigid edge restraint, AE175FM Profile Height 75mm, Length 2500mm Horizontal width 75mm, thickness 4mm
- Bluff coloured self binding gravel to podium courtyards
- 20-25mm Self binding gravel on 35-40mm blinding screed on 180-250mm compacted DCE class 808 Hardcore to Engineers Specification on Terran layer and filter fleece on DE 25mm drainage board on Paralon waterproof membrane on Concrete podium slab
- Aluminium angle rigid edge restraint, AE175FM Profile Height 75mm, Length 2500mm Horizontal width 75mm, thickness 4mm
- 20-25mm Self binding gravel on 35-40mm blinding screed on 180-250mm compacted DCE class 808 Hardcore to Engineers Specification on 200mm well compacted subbase

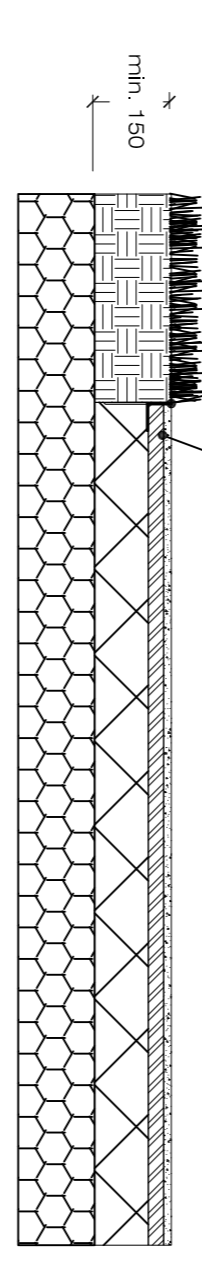

D 02.1 LD-06-PP Section to self binding gravel surface to communal courtyard.  
Scale @ 1:20

REV	DATE	TITLE

Project name:	Heuston South Quarter	Project number:	21-029
Drawing name:	Hardworks Landscapes Surface details	Drawing number:	LD-06-PP

Drawing scale @ A1:	1:20	Drawn by:	dhol	Checked by:	dhol
Scale:	1:20	Date:	17.06.2021		

Planning Application	
Contact details:	Other address: